

# **THE SUMMERFIELDS SPOTLIGHT** **FOCUS ON THE NEIGHBORHOOD**

A COMMUNITY WHERE DIVERSITY  
IS VALUED, COMMUNICATIONS  
ARE ENCOURAGED AND AN  
ATTITUDE OF LEARNING FROM  
ONE ANOTHER IS RESPECTED

A Publication of the Summerfields Neighborhood Association

July 2021

## FINALLY, WE CAN MEET AGAIN!

We are very pleased to announce the SNA will resume quarterly meetings this month. Our first meeting since January 2020 will be held From 6 to 8 PM on Monday, July 26th, at the Summerglenn Library Meeting Room. We so look forward to meeting with our members. We need your ideas and concerns. We need new board members with new ideas. We need our residents to be active in their association to be successful. In short, we need you.

We have tried to keep you updated during the pandemic by posting our monthly newsletter, The Spotlight, on our web site. But there is so much to cover and with the time restraints we may have to spread it out over the first couple of meetings. We will try to get everyone updated on what we've been doing for the last 18 months. But we also want you to be aware of the upcoming Fort Worth City Council redistricting process, potentially one of the most impactful changes our area will see in the near future. Redistricting will add two new council districts and redraw the boundaries of the nine existing districts. We have asked Barry Cram, our liaison with Fort Worth's Community Engagement Office, to give a brief presentation on how citizens can participate in the upcoming redistricting effort. It is my fervent hope that Summerfields will stay in the same district as other neighborhoods north of the loop.

We also want to re-engage with the effort we started last January to bring our members into more active participation in the SNA. We had six members volunteer to assist, but before we could fully engage in this effort the pandemic put everything on hold. We know we need to foster new members for future officer and board positions. We thank those who stepped up. We look forward to renewing our effort to grow the SNA.

We want to thank you for staying with the SNA during the pandemic. To err on the side of caution, masks will be optional for those who have been vaccinated. If not vaccinated, we ask that you wear a mask. Thank you.

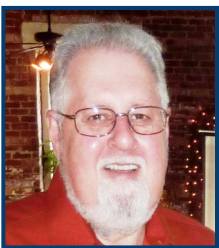

## SNA Presidents Corner

I hope everyone had a good July 4th holiday. On this special day we encourage everyone to reflect on the principles upon which this country was founded, as well as the ongoing changes needed to assure all citizens have equal access to the rights and privileges guaranteed them by the US. Constitution.

We had to wait on the new Summerglenn Library hours to be posted before we could schedule our next two SNA Membership Meeting. We just recently received those hours and reserved their meeting room for the July and October 2021 meetings. Those two dates are July 26th and October 11th, from 6 to 8 PM. We had to move the October meeting forward a couple of weeks due to the last half of the October already earmarked as a voting site.

We want you to know, your SNA Board did not sit idly by during the pandemic. We continued to work infrastructure issues in the neighborhood. In 2020 alone we reported over 130 inoperative street lights in the Summerfields area. Additionally, we were very active reporting City Code violations, most involving incorrect disposal of trash, recyclables, and bulk waste. We also made many reports of public easements as well as residences with high grass and weeds. Our goal is to keep Summerfields a viable community where families can enjoy an attractive, safe and secure lifestyle. We need everyone's help in doing so.

### Table of Contents

**Pg 2-3 Development**

**Pg 4 City News**

**Pg 5-6 Code Info**

**Pg 7 Crime Map**

## KISD School Construction Has Begun in our Area

Three schools in our area are in different stages of construction. The new Heritage Elementary facility has been under construction for almost a year. It is scheduled to be completed by the end of July 2021, in time for the new school year. After the new building is completed, the old Heritage Elementary facility will be taken down.

Construction has commenced at Parkview Elementary School. The construction phase officially started April 1st, 2021. off and on road closures on Bayberry and Longstow are coming. The old facilities will be torn down in stages, the current facility has to support students for the 2021/22 school year. After completion of the new two story structure most of the current school will then be taken down. Part of Summerfields Park has been fenced in to house construction equipment. The project is scheduled to complete in June 2022.

The construction phase of the renovation of Fossil Hill Middle School started on April 1st. Fencing has been installed in the parking lot behind the school. The renovation is scheduled to complete in June 2022.

## Developments Currently in Progress

A convenience store is under construction at 4550 Basswood Blvd., just to the east-of Ace Hardware. Long-time residents may remember that this site originally had a privately run recreational facility with tennis courts and a swimming pool. It went out of business in the early 1990s.

A Goodwill Industries store and drop-off station is complete at the southeast intersection of Basswood and Sandshell Blvds. They are hiring workers and are very close to opening.

A car wash is under construction at the southwest intersection of Sandshell and Basswood Blvds. Signs on the property indicate they are now hiring for car wash staff.

## Standard Multi-Family Apartments Proposed In Our Area



A zoning change has been approved to allow construction of a 200 unit apartment complex on the land bordered by Fossil Bluff, Hartnett, and Sandshell Blvd. This is the land just to the south of the Carriage Place townhomes who's Association the SNA supported during the zoning process.

While the SNA has traditionally opposed new standard multi-family zoning changes, this is not a normal situation. This site is currently zoned G, high intensity commercial. This type of zoning allows several large non-residential facilities such as the Main Event bowling and gaming center in the Presidio Shopping area. Because of the risk of such G-zoned facilities with their negative impacts on traffic and crime, we conditionally supported building apartments on this land/



Concept Drawings from the Developer. Final design is yet to be finalized.

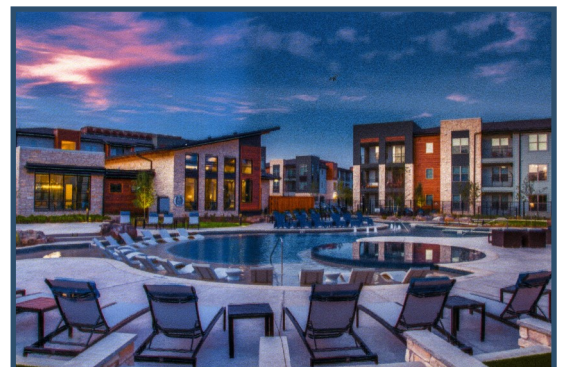



## Area Road Construction Updates

The Basswood and N. Beach intersection improvement project, funded in the City's last Capital Improvement Program (CIP) bond package, started in April. This project will install two turn lanes in every direction to help alleviate traffic congestion at this busy intersection. It will also install curb crossings at all intersections, update the traffic light system, and add lane signs. It is scheduled to complete in December 2021.

The construction to widen N. Riverside Drive to a four lane road from N. Tarrant Parkway south to Basswood Elementary school is complete. The four lane roadway with two roundabouts is complete. The Summerfields Blvd. lane extension from Cannonwood to the N. Riverside Dr. roundabout is also finished.

The project to widen N. Riverside Drive to a four lane road from North Tarrant Parkway northward to the Shiver Road roundabout started this month. Completion is scheduled for August 2022. This second N. Riverside Drive road improvement project will provide four lanes from N. Tarrant Parkway northward to the existing Shiver Road traffic circle. It will also rework all four sides of the N. Tarrant and N. Riverside intersection complete with updated traffic signals.

The residents on Creekfall are experiencing the inconveniences encountered when the City does a complete replacement of the street substructure and curbs. We live on Longleaf Lane which had this done about ten years ago, so we can share your pain.

---

## Other Developments

The old Boston's Gourmet Pizza restaurant, located on the southbound I35W access road (behind Joe's Crab Shack), is being renovated. Plans are to open a cigar bar at this location. No opening date is known.

The construction on North Beach near the Wal-Mart parking lot will house a Starbucks. No opening date is known.

Takara Japanese Restaurant is now open at 3088 Basswood Blvd. This space was previously occupied by a Chinese Buffet that closed down last year. Takara applied for a variance that would allow them to sell liquor, beer and wine with their meals.

A Penny Paws veterinarian clinic plans to build at 3800 Basswood Blvd., just east of the existing 7-11.

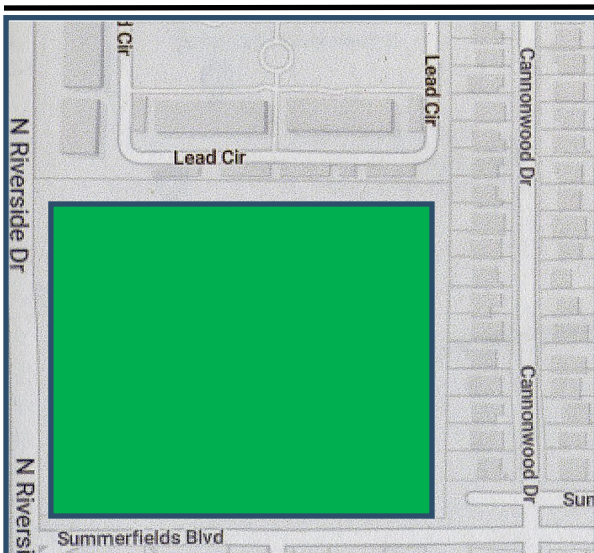

With the completion of the southern N. Riverside and Summerfields Blvd. road projects, construction has started on the seniors only (55+) multi-family project. The SNA supported this project because we felt it was a better fit than what could be built under the old commercial zoning. It is a good fit for that location. It will have a minimal traffic footprint, offer a much needed housing option to area seniors, and pay KISD school taxes without adding any children to the school system. We thought these positives outweighed the loss of a weed-filled field full of low quality trees or a possible strip center.



Concept  
Drawing

# Crime Prevention Programs

The City of Fort Worth and the Fort Worth Police Department offer many crime prevention programs for its residents. Two of the most popular are Crime Watch and Citizens on Patrol. Fort Worth has thousands of volunteers currently active in these two programs and both have proven very effective in reducing neighborhood crime. Summerfields has active volunteers in both programs.



Crime Watch is a very successful national program administered by the Fort Worth Police Department. Crime Watch establishes and trains a block of neighbors on how to look after their street. Once a sufficient number of residents in a block are organized, Crime Watch signs are posted on their street and they are trained on how to identify and report possible criminal activities they observe. Who better than the people who live on a street to notice out of place cars and suspicious activity. It's simply good neighbors knowing what to look for and watching out for each other. If you are interested in forming a Crime Watch on your street, you can contact FWPD Crime Prevention Specialist Rosalinda Mendoza at 817-392-3170.



The Citizen on Patrol (COP) program trains citizen volunteers to actively patrol their community in cars, on foot, or on bicycles. Once volunteers pass a background check, complete a four hour training class, and complete a training ride with an experienced Cop patroller, they patrol their neighborhood. Upon completion of the training these volunteers are issued police radios and equipment and are ready to patrol on their own.

COP patrollers carry no weapons. There are no scheduled patrols, volunteers simply go out when they have the time. These patrols are strictly non-confrontational, COP patrollers do not approach or get involved in any way with possible offenders. They simply act as extra eyes and ears for the police. They observe, report, and stay at a safe distance from the incident they are observing. Fort Worth's Citizen on Patrol program has received national and international attention.

If you are interested in joining Citizens on Patrol, you can contact the North Division COP Coordinator Cindy Strause at 817-392-3172.

---

## City Drop-Off Locations

The City of Fort Worth is ready to help you dispose of bulky trash, yard waste, chemicals and electronics.

Four drop-off locations provide residents a one-stop drop for everything from household and yard chemicals to bulky trash and furniture to yard trimmings. Residents can easily access the drive through and dispose of these items.

You can dispose of items like TVs and electronics, household and yard chemicals that are not picked up by the trash, recycle or bulk waste trucks. Items such as electronics,, household, yard and pool chemicals, automotive fluids, batteries, light bulbs and paint contaminate a landfill and must be properly recycled.

The drop-off stations are free to Fort Worth homeowners and are open on Monday through Saturday. Residents must provide a Fort Worth water bill or current drivers license with a Fort Worth address. Renters can drop off recyclables only if they present a current Fort Worth water bill.

### Drop-off Locations

Hillshire Drop-off Station  
321 Hillshire Drive, Haslet

Southeast Drop-off Station  
5150 Martin Luther King Freeway

Brennan Drop-off Station  
2400 Brennan Avenue

Old Hemphill Road Drop-off Station  
6260 Old Hemphill Road

Our main code issue in Summerfields is solid waste incorrectly placed curbside. Not following the guidelines usually results in waste not picked up, which detracts from the street's appearance and can lead to fines. No one wants to live in a neighborhood with trash sitting by the street for too long. It detracts from the neighborhood's appearance, makes selling homes more difficult, and eventually lowers property values. Because of this the SNA aggressively monitors waste disposal violations and reports them to Code Compliance. We do not like reporting violations that can result in fines, but there is often no alternatives left to us, We much prefer that residents become educated on the City's waste disposal processes, but will not stand idle while trash accumulates in our neighborhood.

The following are the most common violations we observe:

- Plastic bags containing solid waste (including leaves) placed curbside. *Anything in a plastic bag must be placed in the brown garbage cart to be picked up.* Hardware stores sell acceptable paper yard bags for disposing of yard recyclable waste such as clippings, leaves and small branches
- Bulk waste placed curbside too early, sometimes up to three weeks before the next scheduled pickup. Doing so detracts from the street's appearance and could impact neighbors trying to sell their homes.
- Placing bulk waste too close to objects in the yard. Many of the trucks use hydraulic arms to load waste, and if you place it too close to objects such as mail boxes or light poles it may prevent them from picking it up.
- Different types of bulky waste mixed together. Brush and paper-bagged leaves should be separated from furniture and other bulk items. They are picked up by different trucks and go to different locations. Brush and yard clippings are taken to a City facility where along with the paper bags are converted into mulch. This is the main reason they will not pick up yard waste in non-recyclable plastic bags.
- Mixing waste and recyclable items in the Recycle container. Waste and recyclables are picked up by different trucks. Contaminating the Recycle container with household waste will result in the bin not being emptied.
- Placing household and yard chemicals in the recycle or trash containers. These items should be taken to the Environmental Collection Center (ECC) on Bridge Street. You simply drive though, show your driver's license to show you are a Fort Worth resident, and they empty your vehicle for you. See details on the City's web site.
- Placing any electronic item or major appliance curbside for pick up. All electronics should be taken to Brennen Street for disposal. Electronic items such as TVs have integrated circuitry that contain hazardous chemicals such as arsenic. They are disposed of separately so as not to contaminate the landfills.
- Overflowing Waste and Recycle bins. Called "snow cones" because the lid cannot be closed, they can result in the bin not being emptied. Again, the trucks are automated and if the operator feels they cannot empty the container without spillage they will usually bypass the container, thus leaving the resident with another week before it is again eligible for pick up.
- Trash bins left on the street for days after the scheduled pickup date.

Also remember that small limbs (less than 8 feet in length and four inches in diameter) can be placed curbside for pickup with your scheduled weekly trash. Only larger limbs have to wait for the monthly bulk pick up..

## BULK WASTE GUIDELINES

**Note: Bulk pickup week for Summerfields begins on the second Monday of each month and runs through the following Saturday. Bulk waste should not be placed curbside until the weekend before your scheduled pickup week. For more information we urge our residents to visit the Solid Waste webpage on the City's website (see the link at the end of this article).**

The following information was provided by the City of Fort Worth Solid Waste Department:

**Bulk collection is once a month. The New guidelines are in place, so brush up before your next monthly collection**

The city's Solid Waste Services has new easy-to-follow steps to make residential bulk collection safer and more effective for pickup. (continued on page 6)



## BULK WASTE GUIDELINES—Continued from page 5

The goal is to not only collect the waste, but to dispose of it in a safe manner and, when possible, keep it out of the landfill. For example, tree limbs, branches and yard waste are turned into mulch.

To help curbside pickup go as smoothly as possible, follow the program directions and avoid incurring fines. Here are some best practices and program guidelines:

- Bulk items must be placed on the curb by 7 a.m. Monday of your scheduled collection week. Make sure the pile is not blocked by a vehicle.
- Bulk piles are limited to 10 cubic yards (6 feet by 8 feet by 6 feet), the size of a Volkswagen bug car.
- Plastic bags are not allowed outside the trash cart; residents may incur fines if plastic bags are placed curbside.
- All piles, paper yard waste bags and carts must be separated by at least 2 feet to be collected and to avoid extra fees. No materials can be placed between piles since this creates one large, out-of-compliance pile.
- Any items that fit in the brown garbage cart are not considered bulk and should be put in plastic bags and then placed into the brown garbage cart.
- Large limbs refers to those more than 4 inches in diameter and over eight feet long. Brush smaller than this is considered yard waste and can be collected at the curb on your weekly trash pickup day as part of the yard waste collection program. It must be separated from items like mail boxes, carts, large limbs and any bulk piles

To learn more about the program details, including what materials cannot be set out for bulk collection, check the Solid Waste webpage. <http://fortworthtexas.gov/solid-waste/bulk/>.

Solid Waste Services At-A-Glance					
Questions? Download the Fort Worth Garbage & Recycling App					
	WHEN	HOW	AMOUNT/SIZE	DETAILS	NO
<b>YARD</b>	Weekly on pickup day; set out by 7 a.m.	In paper bags, or optional purchase of green yard cart	Unlimited paper yard bags - 30 gallon size	Place 2 ft. from carts or other objects (cars, trees, mailboxes, water and gas meters.)	No plastic bags or trash
<b>Yard Trimmings</b> Leaves, twigs, grass, shrubs					
<b>Brush, Tied</b> Small Branches	Weekly on pickup day; set out by 7 a.m.	Bundled, tied with string or twine	Unlimited bundles, 8 ft. long, 40 lb. max	Place 2 ft. from carts or other objects	No nylon or plastic straps, ties or wire
<b>Brush, Untied</b> Large Branches	Weekly on pickup day; set out by 7 a.m.	Stacked branches only. All branches should be in one pile	Limited to 10 cubic yards (8 ft. long x 6 ft. wide x 6 ft. tall) max, about size of VW Beetle car. Branches no longer than 8 ft. and up to 4 inches in diameter	Place 2 ft. from carts or other objects. More than 10 cubic yds. collected within 72 hours billed to resident	No stumps, plastic bags, trash, fencing, lumber, or household bulk items
<b>RECYCLING</b>	Weekly on pickup day; set out by 7 a.m.	Unbagged items. Close cart lid completely. Clean, dry and empty items.	As much recycling as can fit with the blue cart lid closed. Second blue cart available on request - free.	May take extras to a drop-off station. Only put acceptable items in the cart. Place 2 ft. from carts or other objects	No plastic bags, Styrofoam, paper towels, food, plastic wrap, electronics, clothes, medical waste
Visit website or app for all items that can be recycled. <b>Blue Cart</b>	Can set cart out after 6 p.m. the day before your pickup day				
<b>GARBAGE</b>	Weekly on pickup day; set out by 7 a.m.	In tied plastic bags inside brown cart. Close lid completely. Place 2 ft. from carts or other objects.	Your choice: a -32, 64- or 96-gallon cart (price varies with size). As many bags as can fit in brown cart with lid closed	Options for extra garbage: 1. Take to drop-off station 2. Upgrade cart size 3. Purchase city-authorized Pay Bags	No unbagged items; no bags outside cart or stacked on cart
Household waste only. <b>Brown Cart</b>	Can set cart out after 6 p.m. the day before your pickup day				
<b>BULK ITEMS</b>	Monthly on pickup day; set out by 7 a.m. the Monday of your assigned week; pickup will be any time between that Monday and Saturday	Stacked on curb in one pile. Acceptable items that are too large to fit in the garbage cart. Separate household bulk and large brush piles	Limited to 10 cubic yds. (8 ft long x 6 ft. wide x 6 ft. tall) max; size of a VW Beetle car. More than 10 cubic yds. billed to resident.	Can be set out after 6 p.m. the Friday before your assigned week. Includes fencing, stumps, lumber in bulky pile. Take extra to a drop-off station	No plastic bags, tires, glass, business waste, electronics, sheet-rock, or appliances with coolant or gas
For items too heavy/bulky for the cart. Visit the website or app for more details. Place 2 ft. from carts or other objects.					
<b>DROP-OFF STATIONS</b>	Open: M-F 8 a.m. - 6 p.m. Sat 8 a.m.- 5 p.m. (Hours subject to change)	Drop-off Station #1: 2400 Brennan Ave. 76106 Drop-off Station #2: 5150 Martin Luther King Jr. Frwy 76119 Drop-off Station #3: 6260 Old Hemphill Rd. 76134 Drop-off Station #4: 301 Hillshire 76052		Bring a recent water bill, drivers license or other official ID to prove Fort Worth residency	No commercial waste, no rock or concrete
Fort Worth Residents Only. Accepting recyclables, brush, electronics, items for Goodwill and more!	Free for Fort Worth Residents				



## Summerfields Area Crime Map for June 2021

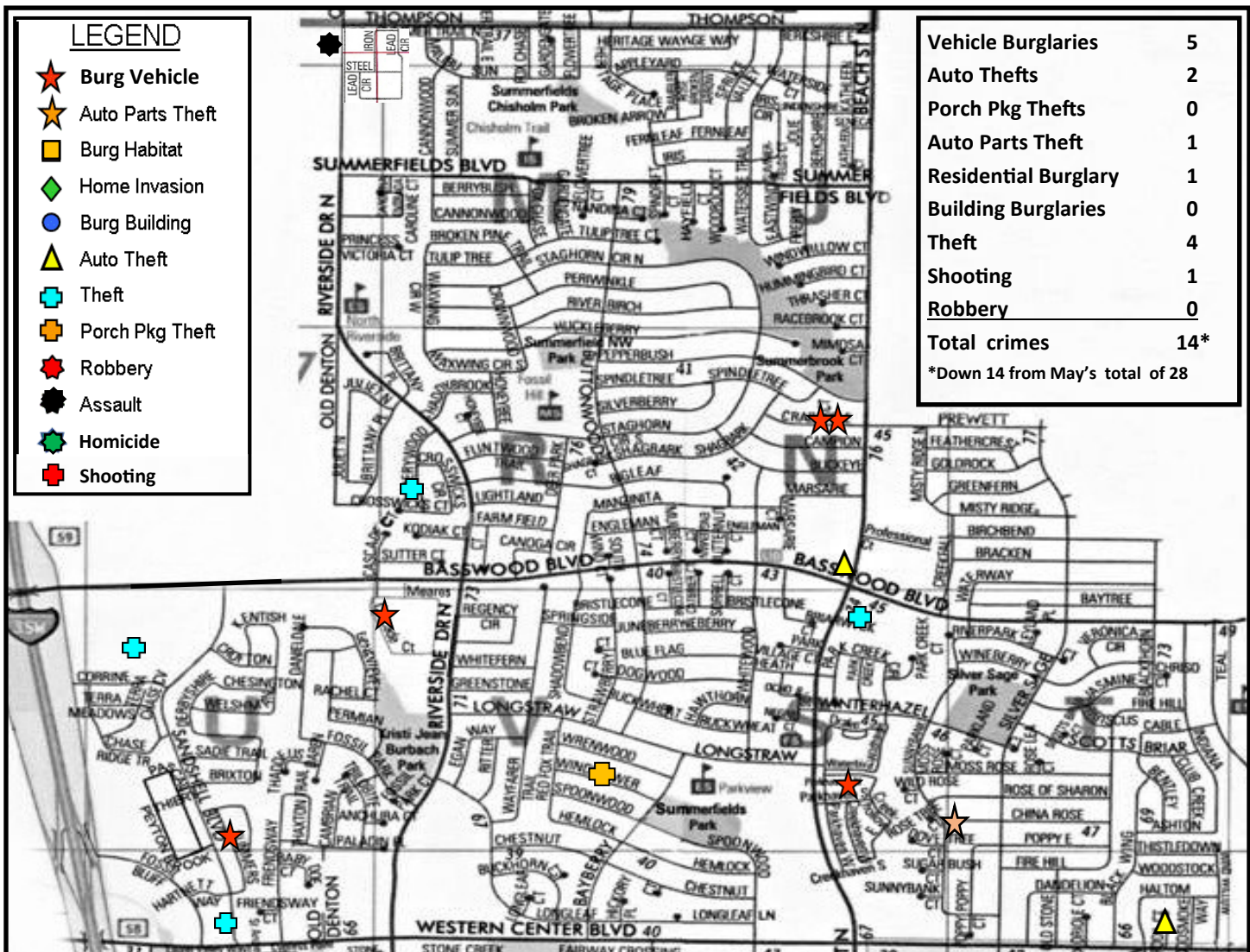

### Summerfields Crime Trends for June 2021:

- June saw a big drop in area crime. This can be directly attributed to several special early morning details by FWPd officers and Citizens on Patrol volunteers which identified several serial thieves working our area.
- It is strongly recommended that vehicles parked outside a garage be locked and nothing left in view.
- The City is seeing an increase in violent crimes—assaults, homicides, robberies and shootings. Most North Division violent crimes are domestic related.
- All of Fort Worth is seeing a spike in catalytic converters taken from a vehicle parked outside and at businesses.

### Crime Prevention Recommendations:

- If you park your car in the driveway, on the street or in a business parking lot, make sure it's locked. Most car burglaries are of unlocked vehicles. We have car burglars from all over Fort Worth come to our area and police say this is because our area has a reputation among thieves for not securing our property!
- Do not leave anything visible from the outside the vehicle. Doing so could motivate a burglar to forcibly enter.
- Close and lock your garage door. Remember, the door from your garage into your house is usually very flimsy!
- Request an assessment of your homes security from FWPd North Division Crime Prevention Specialist Rosalinda Mendoza (817-392-3170). She will survey your home and make recommendations on how to increase your security.
- Report juveniles walking the residential streets after midnight., especially if the wear hoodies and have backpacks.