

THE SUMMERFIELDS SPOTLIGHT

FOCUS ON THE NEIGHBORHOOD

A COMMUNITY WHERE DIVERSITY
IS VALUED, COMMUNICATIONS
ARE ENCOURAGED AND AN
ATTITUDE OF LEARNING FROM
ONE ANOTHER IS RESPECTED

A Publication of the Summerfields Neighborhood Association

February 2021

Fort Worth Selects New Police Chief

By Lance Griggs, Summerfields Neighborhood Association President



The City of Fort Worth has selected Neil Noakes, who was a Deputy Chief under former Chief Ed Krause, as new Chief of Police of the Fort Worth Police Department. Chief Noakes, a 20+ year veteran with FWPD, served in numerous capacities within the Department., including an almost two year stint as Commander of our North Patrol Division. During that time I was privileged to work closely with Neil, and found him to be extremely capable as week as a man of incredible integrity and character. He is highly respected by the rank and file officers. I am proud to call Neil my friend. The following was extracted from the City of Fort Worth Web Site.

Neil Noakes, who has served in the Fort Worth Police Department for more than 20 years, was named police chief by City Manager David Cooke on Monday, January 25th..

“Chief Noakes brings many years of community-based law enforcement experience to the chief’s office, and even more important, he brings innovative leadership and a desire for genuine engagement with the residents we serve,” Cooke said. “In every position throughout his career, Chief Noakes has focused on community problem-solving, reducing crime and enhancing justice and equity for all of our residents.”

Continued in Police Chief on page 2)

SNA Presidents Corner



One of many concerns created by COVID-19 is the rise in crime Fort Worth is experiencing. As was to be expected with a quarantine, domestic disturbance complaints have skyrocketed as families were constrained at home. However, North Division in particular saw a 30+ percent increase in property crime offenses in 2020. Car burglaries and auto thefts have increased dramatically. We are also seeing a rise in catalytic converter and license plate theft from cars parked on the street and in parking lots. Home burglaries, mainly from open garages, are also up. We’ve seen a big rise in business burglaries and robberies.

Because of this, we want to urge our residents to take every possible precaution to avoid being a victim. Lock any cars not secured in a garage. Make sure to leave nothing visible inside that could prompt a burglar to break a window to gain access. Make sure your and your neighbor’s garage doors are closed. If you see suspicious people walking the streets, especially at night, call the FWPD at 817-392-4222 (after it answers, push 1 to bypass a lengthy recording). Put up motion detector lights to discourage criminals from coming onto your property. Work with your neighbors to help watch your street.

Table of Contents

Pg 2-3 Development

Pg 4 City News

Pg 5-6 Code Issues

Pg 7 Crime Map

Police Chief (Continued from page 1)

Noakes has a master of science degree in criminal justice and criminology from Texas Christian University and a bachelor degree in criminal justice administration from Tarleton State University.

Since March 2019 he has been deputy chief of the Fort Worth Police Department. Other positions with FWPD include commander of the North Patrol Division (2017-2019); lieutenant in the Internal Affairs Section (2015-2016); sergeant (2012-2015); corporal/detective (2008-2012); and officer (2000-2008). Noakes is an honor graduate of Class 102 of the Fort Worth Police Academy.

“Chief Noakes is the right leader, at the right time, for the Fort Worth Police Department and the City of Fort Worth,” Mayor Betsy Price said. “Chief Noakes has proven to have a heart for servant leadership and a vision for rebuilding and strengthening relationships within our communities. He and the 2,400-plus sworn and civilian employees of the department must work with the community in a spirit of solidarity and partnership to continue to build on the foundations that Chief Kraus has laid. I look forward to voting on his appointment with the other councilmembers at our February meeting.”

Six finalists were interviewed for the chief’s job after more than 50 original candidates applied for the position.

DEVELOPMENT UPDATE

Standard Multi-Family Apartments Proposed In Our Area

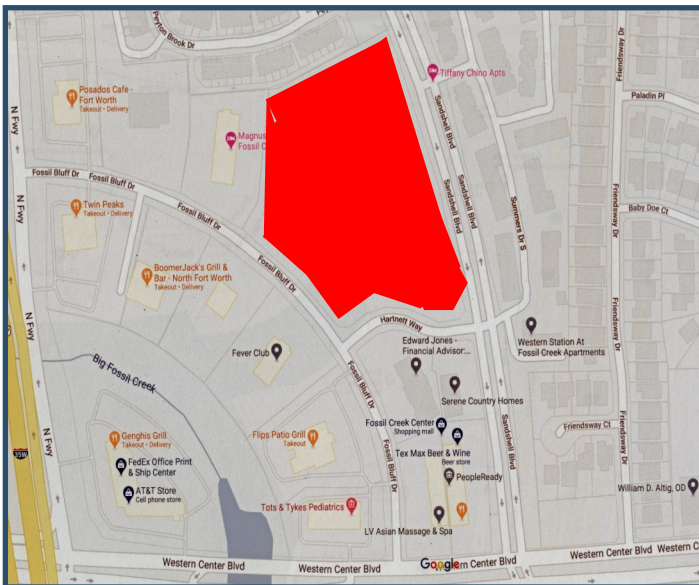

A developer has been working with Councilman Cary Moon and area neighborhood organizations, including the SNA, to construct a 200 unit apartment complex on the land bordered by Fossil Bluff, Hartnett, and Sandshell Blvd. This is the land just to the south of the Carriage Place townhomes who’s Association we are supporting.

While the SNA has traditionally opposed new standard multi-family zoning changes, this is not a normal situation. This site is currently zoned G, high intensity commercial. This type of zoning allows several large non-residential facilities such as the Main Event bowling and gaming center in the Presidio Shopping area. Because of the risk of such G-zoned facilities

building on this land, the SNA has conditionally supported this multi-family development.



Concept Drawings from the Developer.
Final design is yet to be finalized.

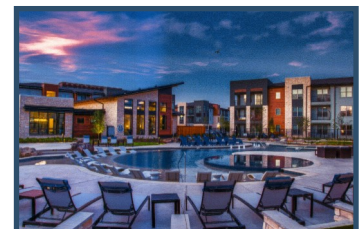

TWO MAJOR SINGLE FAMILY DEVELOPMENTS SLATED FOR FAR NORTH FORT WORTH

The 3,300 single-family home development near Texas Motor Speedway covered in last month's newsletter already has company. Another large development has just been announced. A 2,900 home development is now in the works. This development will be located on Fort Worth land located northwest of Haslet. It is, just north of the existing Sendera Ranch neighborhood. That makes over 6,000 new homes in these two developments, which will house about 25,000 new residents. There will be many more to come.

The economic engine that is Alliance Airport will continue to drive Far North Fort Worth development. Hillwood Development, the builder of Alliance Airport, purchased all the land between the airport and the railhead to its west. The plan is to build a world class logistics center that will attract even more major businesses to our area. There is a very good reason we're seeing all this warehouse construction.

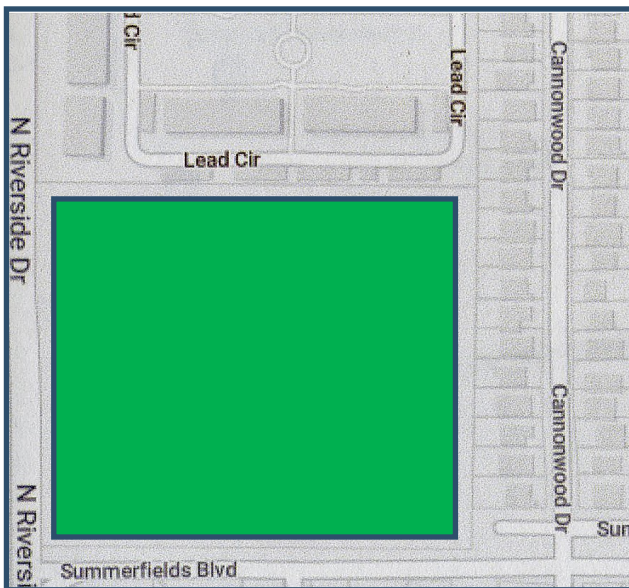

The SNA supported the development of a seniors only (55+) multi-family housing facility on the vacant land located at the northeast intersection of Summerfields Blvd. and N. Riverside Drive. The zoning change request for this facility was approved in August by both the City's Zoning Commission and the City Council.



Concept Drawing

There is no known date for the start of construction, but we'll pass you updated information when we receive it.

Area Road Construction Update

As everyone is probably aware, construction is going full bore on widening N. Riverside Drive to a four lane road from N. Tarrant Parkway south to Basswood Elementary school. This project will also install two traffic circles at the Summerfields Blvd. and Thompson Road intersections with N. Riverside Dr. After a lengthy closure, Thompson Road has reopened to traffic at North Riverside Drive, giving residents easier access when taking to or picking up their children at the Thompson Road Middle School. Please be patient. When completed this will make N. Riverside a four lane road up to North Tarrant. Construction is proceeding well and should be finished, weather permitting, by mid 2021.

A second road improvement project will continue widening N. Riverside Drive from N. Tarrant Parkway north to the existing traffic circle/four lane road at Shiver Road. It is funded and in the design phase. This project will not begin until the current N. Riverside project is complete. This means we have a couple of years before N. Riverside is a four lane road throughout the area.

Other road improvements are planned for the Basswood Blvd. and N. Beach intersection. This project was funded in the City's last Capital Improvement Program and will install two turn lanes in every direction to help alleviate traffic congestion at this busy intersection. No start date is known.

Income Tax Preparation Assistance is Available

Extracted from City Web Site

Taxpayers who make less than \$60,000 per year can get help filing their returns. The VITA program also helps low- to moderate-income taxpayers claim valuable tax credits.

Volunteer Income Tax Assistance, or VITA for short, is an IRS-supported program. Community volunteers, certified by the IRS, help taxpayers prepare their 2020 tax returns at no cost and make sure they claim appropriate tax credits such as the Earned Income Tax Credit and Child Tax Credit.

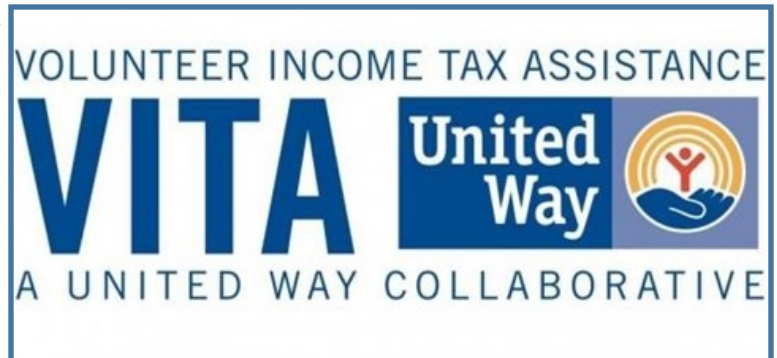

- 1 The program provides assistance online and via email through the April 15 filing deadline. Here are the steps:
- 2 Complete the required online forms. Use the checklist to identify potential savings.
- 3 Watch for a confirmation email from VITA; reply to confirm phone appointment.
- 4 Choose one of seven curbside drop-off locations to deliver tax documents.
- 5 Watch for completed tax return by email; review for accuracy.
- 6 Agree to allow VITA to submit your tax return electronically; save a copy.

Taxpayers must schedule an appointment to drop off documents at one of these locations:

- **MLK Community Center**, 5565 Truman Drive. Site opens Feb. 2. Open 2-6 p.m. Tuesdays and Thursdays.
- **Northside Public Library**, 601 Park St. Site opens Feb. 6. Open 9 a.m. to 2 p.m. Saturdays.
- **Opening Doors for Women In Need**, 3600 Horne St. Site opens Feb. 2. Open 2-7 p.m. Tuesdays, Wednesdays and Fridays.
- **Southside Community Center**, 959 E. Rosedale St. Site opens Feb. 1. Open 1-5 p.m. Tuesdays, Wednesdays and Fridays.
- **GRACE**, 837 E. Walnut St., Grapevine. Site opens Feb. 1. Open 2-7 p.m. Monday-Wednesday and 2-7 p.m. Friday.
- **Mission Center**, 901 W. Broad St., Mansfield. Site opens Feb. 4. Open 2-7 p.m. Thursdays and Fridays; and 9 a.m. to 2 p.m. on the second Saturday of the month.
- **Community Enrichment Center**, 6250 N.E. Loop 820, North Richland Hills. Site opens Feb. 1. Open 2-7 p.m. Mondays and Wednesdays; 3-7 p.m. Thursdays; 9 a.m. to 2 p.m. Saturdays.

When you arrive for your appointment, remain in your vehicle. Staff will copy documents and return the originals.

For questions, [email the VITA program](#) or call 817-392-5698.

Our main code issue in Summerfields is solid waste incorrectly placed curbside. Not following the guidelines usually results in waste not picked up, which detracts from the street's appearance and can lead to fines. No one wants to live in a neighborhood with trash sitting by the street for too long. It detracts from the neighborhood's appearance, makes selling homes more difficult, and eventually lowers property values. Because of this the SNA aggressively monitors waste disposal violations and reports them to Code Compliance. We do not like reporting violations that can result in fines, but there is often no alternatives left to us, We much prefer that residents become educated on the City's waste disposal processes, but will not stand idle while trash accumulates in our neighborhood.

The following are the most common violations we observe:

- Plastic bags containing solid waste (including leaves) placed curbside. *Anything in a plastic bag must be placed in the brown garbage cart to be picked up.* Hardware stores sell acceptable paper yard bags for disposing of yard recyclable waste such as clippings, leaves and small branches
- Bulk waste placed curbside too early, sometimes up to three weeks before the next scheduled pickup. Doing so detracts from the street's appearance and could impact neighbors trying to sell their homes.
- Placing bulk waste too close to objects in the yard. Many of the trucks use hydraulic arms to load waste, and if you place it too close to objects such as mail boxes or light poles it may prevent them from picking it up.
- Different types of bulky waste mixed together. Brush and paper-bagged leaves should be separated from furniture and other bulk items. They are picked up by different trucks and go to different locations. Brush and yard clippings are taken to a City facility where along with the paper bags are converted into mulch. This is the main reason they will not pick up yard waste in non-recyclable plastic bags.
- Mixing waste and recyclable items in the Recycle container. Waste and recyclables are picked up by different trucks. Contaminating the Recycle container with household waste will result in the bin not being emptied.
- Placing household and yard chemicals in the recycle or trash containers. These items should be taken to the Environmental Collection Center (ECC) on Bridge Street. You simply drive though, show your driver's license to show you are a Fort Worth resident, and they empty your vehicle for you. See details on the City's web site.
- Placing any electronic item or major appliance curbside for pick up. All electronics should be taken to Brennen Street for disposal. Electronic items such as TVs have integrated circuitry that contain hazardous chemicals such as arsenic. They are disposed of separately so as not to contaminate the landfills.
- Overflowing Waste and Recycle bins. Called "snow cones" because the lid cannot be closed, they can result in the bin not being emptied. Again, the trucks are automated and if the operator feels they cannot empty the container without spillage they will usually bypass the container, thus leaving the resident with another week before it is again eligible for pick up.
- Trash bins left on the street for days after the scheduled pickup date.

Also remember that small limbs (less than 8 feet in length and four inches in diameter) can be placed curbside for pickup with your scheduled weekly trash. Only larger limbs have to wait for the monthly bulk pick up..

BULK WASTE GUIDELINES

Note: Bulk pickup week for Summerfields begins on the second Monday of each month and runs through the following Saturday. Bulk waste should not be placed curbside until the weekend before your scheduled pickup week. For more information we urge our residents to visit the Solid Waste webpage on the City's website (see the link at the end of this article).

The following information was provided by the City of Fort Worth Solid Waste Department:

Bulk collection is once a month. The New guidelines are in place, so brush up before your next monthly collection

The city's Solid Waste Services has new easy-to-follow steps to make residential bulk collection safer and more effective for pickup. (continued on page 6)

BULK WASTE GUIDELINES—Continued from page 5

The goal is to not only collect the waste, but to dispose of it in a safe manner and, when possible, keep it out of the landfill. For example, tree limbs, branches and yard waste are turned into mulch.

To help curbside pickup go as smoothly as possible, follow the program directions and avoid incurring fines. Here are some best practices and program guidelines:

- Bulk items must be placed on the curb by 7 a.m. Monday of your scheduled collection week. Make sure the pile is not blocked by a vehicle.
- Bulk piles are limited to 10 cubic yards (6 feet by 8 feet by 6 feet), the size of a Volkswagen bug car.
- Plastic bags are not allowed outside the trash cart; residents may incur fines if plastic bags are placed curbside.
- All piles, paper yard waste bags and carts must be separated by at least 2 feet to be collected and to avoid extra fees. No materials can be placed between piles since this creates one large, out-of-compliance pile.
- Any items that fit in the brown garbage cart are not considered bulk and should be put in plastic bags and then placed into the brown garbage cart.
- Large limbs refers to those more than 4 inches in diameter and over eight feet long. Brush smaller than this is considered yard waste and can be collected at the curb on your weekly trash pickup day as part of the yard waste collection program. It must be separated from items like mail boxes, carts, large limbs and any bulk piles

To learn more about the program details, including what materials cannot be set out for bulk collection, check the Solid Waste webpage. <http://fortworthtexas.gov/solid-waste/bulk/>.

Solid Waste Services At-A-Glance					
Questions? Download the Fort Worth Garbage & Recycling App					
	WHEN	HOW	AMOUNT/SIZE	DETAILS	NO
YARD	Weekly on pickup day; set out by 7 a.m.	In paper bags, or optional purchase of green yard cart	Unlimited paper yard bags - 30 gallon size	Place 2 ft. from carts or other objects (cars, trees, mailboxes, water and gas meters.)	No plastic bags or trash
Yard Trimmings Leaves, twigs, grass, shrubs					
Brush, Tied Small Branches	Weekly on pickup day; set out by 7 a.m.	Bundled, tied with string or twine	Unlimited bundles, 8 ft. long, 40 lb. max	Place 2 ft. from carts or other objects	No nylon or plastic straps, ties or wire
Brush, Untied Large Branches	Weekly on pickup day; set out by 7 a.m.	Stacked branches only. All branches should be in one pile	Limited to 10 cubic yards (8 ft. long x 6 ft. wide x 6 ft. tall) max, about size of VW Beetle car. Branches no longer than 8 ft. and up to 4 inches in diameter	Place 2 ft. from carts or other objects. More than 10 cubic yds. collected within 72 hours billed to resident	No stumps, plastic bags, trash, fencing, lumber, or household bulk items
RECYCLING	Weekly on pickup day; set out by 7 a.m.	Unbagged items. Close cart lid completely. Clean, dry and empty items.	As much recycling as can fit with the blue cart lid closed. Second blue cart available on request - free.	May take extras to a drop-off station. Only put acceptable items in the cart. Place 2 ft. from carts or other objects	No plastic bags, Styrofoam, paper towels, food, plastic wrap, electronics, clothes, medical waste
Visit website or app for all items that can be recycled. Blue Cart	Can set cart out after 6 p.m. the day before your pickup day				
GARBAGE	Weekly on pickup day; set out by 7 a.m.	In tied plastic bags inside brown cart. Close lid completely. Place 2 ft. from carts or other objects.	Your choice: a -32, 64- or 96-gallon cart (price varies with size). As many bags as can fit in brown cart with lid closed	Options for extra garbage: 1. Take to drop-off station 2. Upgrade cart size 3. Purchase city-authorized Pay Bags	No unbagged items; no bags outside cart or stacked on cart
Household waste only. Brown Cart	Can set cart out after 6 p.m. the day before your pickup day				
BULK ITEMS	Monthly on pickup day; set out by 7 a.m. the Monday of your assigned week; pickup will be any time between that Monday and Saturday	Stacked on curb in one pile. Acceptable items that are too large to fit in the garbage cart. Separate household bulk and large brush piles	Limited to 10 cubic yds. (8 ft long x 6 ft. wide x 6 ft. tall) max; size of a VW Beetle car. More than 10 cubic yds. billed to resident.	Can be set out after 6 p.m. the Friday before your assigned week. Includes fencing, stumps, lumber in bulky pile. Take extra to a drop-off station	No plastic bags, tires, glass, business waste, electronics, sheet-rock, or appliances with coolant or gas
For items too heavy/bulky for the cart. Visit the website or app for more details. Place 2 ft. from carts or other objects.					
DROP-OFF STATIONS	Open: M-F 8 a.m. - 6 p.m. Sat 8 a.m.- 5 p.m. (Hours subject to change)	Drop-off Station #1: 2400 Brennan Ave. 76106 Drop-off Station #2: 5150 Martin Luther King Jr. Frwy 76119 Drop-off Station #3: 6260 Old Hemphill Rd. 76134 Drop-off Station #4: 301 Hillshire 76052		Bring a recent water bill, drivers license or other official ID to prove Fort Worth residency	No commercial waste, no rock or concrete
Fort Worth Residents Only. Accepting recyclables, brush, electronics, items for Goodwill and more!	Free for Fort Worth Residents				

Summerfields Area Crime Map for January 2021

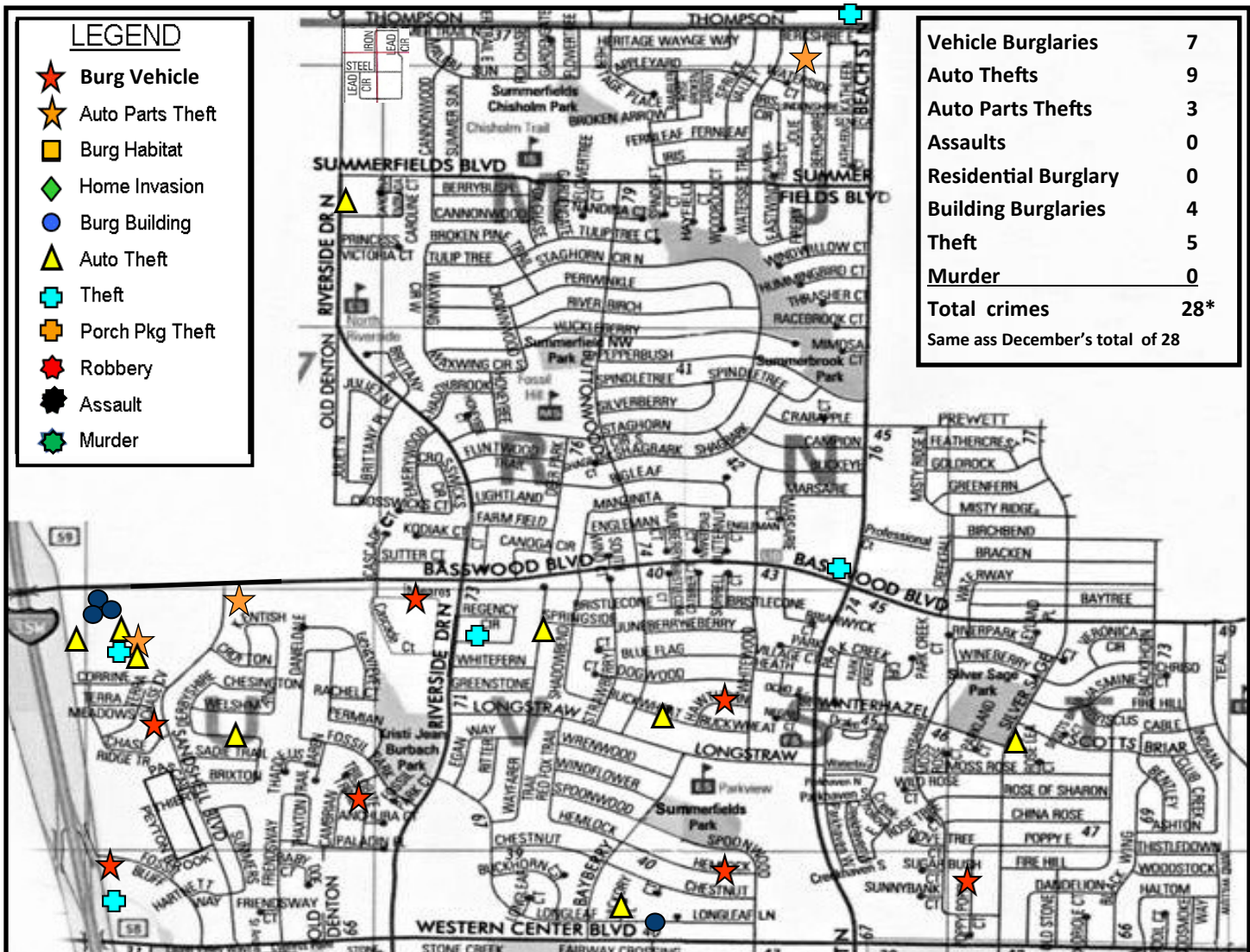

Summerfields Crime Trends for January 2021:

- The majority of car burglaries (BMVs) were of unlocked vehicles, which remains our most common crime. All the BMVs were located between Basswood and Western Center Blvds. It is strongly recommended that vehicles parked outside a garage be locked and nothing left in view from the outside.
- Auto thefts doubled in January.
- We are still seeing a spike in catalytic converters taken from a vehicle parked outside.
- We had four businesses forcibly entered and burglarized.
- **Crime Prevention Recommendations:**
- If you park your car in the driveway, on the street or in a business parking lot, make sure it's locked. Most car burglaries are of unlocked vehicles. Citizens on Patrol recently directed patrol officers to four actors on Friendsway who were walking the streets pulling on door handles to find unlocked cars. They had driven to our area from East Fort Worth. Police say this is not uncommon because our area has a reputation among thieves for not securing our property!
- Do not leave anything visible from the outside the vehicle. Doing so could motivate a burglar to enter it forcibly.
- Close and lock your garage door. Remember, the door from your garage into your house is usually very flimsy!
- Install motion detector LED lights to illuminate your driveway and property - criminals like the dark.
- Report juveniles walking the residential streets after midnight., especially if the wear hoodies and have backpacks.