

THE SUMMERFIELDS

A COMMUNITY WHERE DIVERSITY
IS VALUED, COMMUNICATIONS
ARE ENCOURAGED AND AN
ATTITUDE OF LEARNING FROM
ONE ANOTHER IS RESPECTED



SPOTLIGHT

FOCUS ON THE NEIGHBORHOOD

A Publication of the Summerfields Neighborhood Association

November 2020

KISD SCHOOL IMPROVEMENT PROJECTS

Information extracted from Keller ISD Web Page Documents

Keller ISD passed a \$315 million bond package in 2019 that funds major district-wide updates, including new school construction to replace aging campuses. Below are the projects funded by bond package:

- District-Wide Safety & Security Upgrades | \$19,679,692
- District-Wide Mechanical & Life Safety Upgrades | \$30,800,715
- District-Wide Technology Upgrades | \$24,328,980
- Florence Elementary School Replacement | \$29,949,883
- Heritage Elementary School Replacement | \$31,146,873
- Parkview Elementary School Replacement | \$33,521,597
- Whitley Road Elementary School Replacement | \$32,328,758
- Fossil Hill Middle School Additions & Renovations | \$18,321,041
- Keller Middle School Additions & Renovations | \$25,414,950
- Indoor Extra-Curricular Program Facilities at High Schools | \$48,626,734
- New Industrial Trades and Agriscience Center | \$21,509,217.

Continued in Summerfields Area KISD School Projects on page 2

SNA Presidents Corner

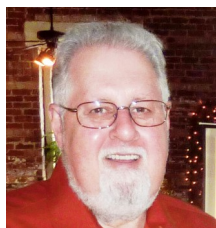

Just have some wandering thoughts this month.

I hope everyone votes in the November 3rd elections. No matter who you support, the key to making a democracy work is the will of the people as expressed through their vote.

We really regret having to cancel our October meeting. We always look forward to meeting you face-to-face and hearing your ideas and concerns. Hopefully we can get back to a more normal lifestyle in the not too distant future, but I'm afraid this pandemic will have some permanent changes to our way of life. Hope I'm wrong. I am, and I'm sure you are also, tired of being cooped up at home. I'm ready to see some Christmas decorations go up in the neighborhood. That always makes me feel good!

That being said I wanted you to know your officers, while not being able to meet in person, are still working hard to keep our area safe and viable. We are still reporting code violations, managing our finances, working with other associations and developers wanting to build in our area, reporting inoperable street lights, and Summerfields Citizen on Patrol group who we support is patrolling our area to help keep crime down.

With pandemic induced rises in unemployment, we have seen some sharp rises in area property crimes. One thing that would help hold crime down is make sure cars parked outside are locked and that nothing is visible from the outside. Car burglaries are our biggest problem. Also make sure your garages are closed when unoccupied.

Table of Contents

Pg 2-4 Development

Pg 5 City News

Pg 6-7 Code Issues

Pg 8 Crime Map

Summerfields Area KISD School Projects—continued from page 1

Heritage Elementary School Replacement

A new Heritage Elementary School campus is currently under construction adjacent to the current building, bringing its learning spaces more in line with other Keller ISD elementary schools and the District's adopted educational specifications. Due to the extensive work needed to update the existing campus and potential costs, the Citizens Bond Advisory Committee proposed the school's complete replacement. Plans call for a two-story facility. Following the construction of the new campus, the current building will be demolished.

Parkview Elementary School Replacement

A new Parkview Elementary School campus will be constructed adjacent to the current building, bringing its learning spaces more in line with other Keller ISD elementary schools and the District's adopted educational specifications. Due to the extensive work needed to update the existing campus and potential costs, the Citizens Bond Advisory Committee proposed the school's complete replacement.. Plans call for a two-story facility. Following the construction of the new campus, the current building will be demolished.

Fossil Hill Middle School Renovation and Expansion

Fossil Hill will see the construction of an extension to its fine arts classrooms including a new band hall, choir classroom, and practice spaces. Existing fine arts spaces as well as core academic spaces will be renovated.

Fossil Ridge High School Improvements

An indoor extracurricular program facility will be constructed at each of Keller ISD's four comprehensive high schools, including Fossil Ridge. The spaces will each include a 100-yard turf field, along with equipment for all outdoor programs. The space would extend opportunities for athletics practices, fine arts rehearsals, and other feeder school activities – such as elementary school field days – providing protection from the elements.

New Industrial Trades and Agriscience Center

A new industrial trades and Agriscience center will be constructed to extend and provide additional career and technical education learning spaces in which to train and prepare students for careers in various trade industries. The proposed center will include a laboratory, shop, and research space for Agriscience programs, emerging technologies, transportation and logistics, and trades such as construction, HVAC, electrical and plumbing. The center will be constructed on land Keller ISD currently owns near the intersection of Golden Triangle Boulevard and North Riverside Drive.

District Wide Safety and Security Upgrades

All Keller ISD campuses except those recommended for replacement will receive updates to security systems and measures to keep the District ahead of ever-evolving threats and create the safest possible learning environment for KISD students. Upgrades will be made to Raptor scanners, access controls, and intercom systems; security vestibules and vestibule check-in systems would be reworked; ballistic film will be added on glazing at school entrances; and additional security cameras will be installed. Additionally, Crisis Counseling Suites with their own dedicated entrance will be added to each intermediate school, serving that feeder pattern's schools.

District-Wide Mechanical & Life Safety Upgrades

High schools, intermediate schools, and elementary schools whose systems have exceeded their expected life cycle will receive replacement HVAC systems, primary power equipment, fire alarm systems, and public address systems.

See projected project schedules for Summerfields area schools on page 3.

KELLER ISD BOND PROJECT SCHEDULES FOR SUMMERFIELDS AREA SCHOOLS

Projects	2020												2021												2022											
	J	F	M	A	M	J	J	A	S	O	N	D	J	F	M	A	M	J	J	A	S	O	N	D	J	F	M	A	M	J	J	A	S	O	N	D
FRHS Extra-Curricular Program Facility																																				
High School Auditorium Upgrades																																				
Fossil Hill Middle School Renovation																																				
Heritage Elementary Rebuild																																				
Parkview Elementary Rebuild																																				
Industrial Trades & Agriscience Center Project																																				
District Wide MEP Projects & Life Safety Upgrades, Group 1																																				
District Wide MEP Projects & Life Safety Upgrades, Group 2																																				
Secure Entry Vestibule Project																																				
Security Infrastructure Projects & Device purchases																																				

= Project in Construction

= Design Phase

= Bid Phase

= Construction Phase



Standard Multi-Family Apartments Proposed In Our Area

A developer has been working with Councilman Cary Moon and area neighborhood organizations, including the SNA, to construct a 200 unit apartment complex on the land bordered by Fossil Bluff, Hartnett, and Sandshell Blvd. This is the land just to the south of the Carriage Place townhomes who's Association we are supporting.

While the SNA has traditionally opposed new standard multi-family zoning changes, this is not a normal situation. This site is currently zoned G, high intensity commercial. This type of zoning allows several large non-residential facilities such as the Main Event bowling and

gaming center in the Presidio Shopping area. Because of the risk of such G-zoned facilities building on this land, the SNA has conditionally supported this multi-family development.



Concept Drawings from the Developer.
Final design is yet to be finalized.

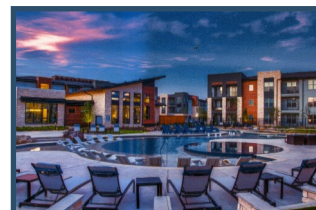

TWO MAJOR SINGLE FAMILY DEVELOPMENTS SLATED FOR FAR NORTH FORT WORTH

The 3,300 single-family home development near Texas Motor Speedway covered in last month's newsletter already has company. Another large development has just been announced. A 2,900 home development is now in the works. This development will be located on Fort Worth land located northwest of Haslet. It is, just north of the existing Sendera Ranch neighborhood. That makes over 6,000 new homes in these two developments, which will house about 25,000 new residents. There will be many more to come.

The economic engine that is Alliance Airport will continue to drive Far North Fort Worth development. Hillwood Development, the builder of Alliance Airport, purchased all the land between the airport and the railhead to its west. The plan is to build a world class logistics center that will attract even more major businesses to our area. There is a very good reason we're seeing all this warehouse construction.

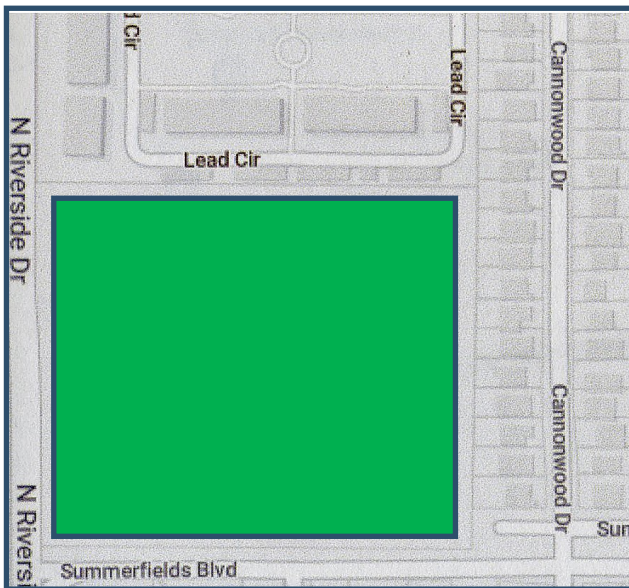

The SNA supported the development of a seniors only (55+) multi-family housing facility on the vacant land located at the northeast intersection of Summerfields Blvd. and N. Riverside Drive. The zoning change request for this facility was approved in August by both the City's Zoning Commission and the City Council.



Concept Drawing

There is no known date for the start of construction, but we'll pass you updated information when we receive it.

Area Road Construction Update

As everyone is probably aware, construction is going full bore on widening N. Riverside Drive to a four lane road from N. Tarrant Parkway south to Basswood Elementary school. This project will also install two traffic circles at the Summerfields Blvd. and Thompson Road intersections with N. Riverside. Currently Thompson Road west of N. Riverside is closed for traffic circle construction. This will make it inconvenient for parents taking to or picking up the children from the Thompson Road Middle School. Please be patient. When completed this will make N. Riverside a four lane road up to North Tarrant. Construction is proceeding well and should be finished, weather permitting, by mid 2021.

A second road improvement project will continue widening N. Riverside Drive from N. Tarrant Parkway north to the existing traffic circle/four lane road at Shiver Road. It is funded and in the design phase. This project will not begin until the current N. Riverside project is complete. This means we have a couple of years before N. Riverside is a four lane road throughout our area.

Other road improvements are planned for the Basswood Blvd. and N. Beach intersection. This project was funded in the City's last Capital Improvement Program and will install two turn lanes in every direction to help alleviate traffic congestion at this busy intersection. No start date is known.

Final Expansion of I35W in Far North Fort Worth is Underway

Congestion relief is on the horizon for Tarrant County as construction has begun on Segment 3C of North Tarrant Express along Interstate-35W in far north Fort Worth.

In September, North Tarrant Infrastructure – the lead contractor on the project – placed the first beams at the interchange of I-35W and SH 170. This officially kicked off the 6.7-mile reconstruction project that will rebuild main lanes, expand frontage roads and add two TEXpress managed lanes in both directions.

Segment 3C, which runs from North Tarrant Parkway to Eagle Parkway, is the final segment scheduled in the \$2.6 billion reconstruction and expansion of 35W, a major north-south corridor that is part of the trade route extending to the U.S.-Mexico border to the south and the Canadian border to the north. The expansion of 35W, which began in 2013, follows the completion of the North Tarrant Express in 2014, a 13-mile project along SH 183/SH 121 and Interstate 820 that was one of the largest public-private partnership transportation projects in the country.

“These major infrastructure projects have transformed mobility within the Dallas-Fort Worth Metroplex,” said Alberto Gonzalez, CEO of the North Tarrant Express and NTE/35W in Tarrant County and the LBJ Express in Dallas County. “We have proven that the managed lanes not only reduce congestion, but also improve safety and provide drivers with reliable travel times when they are trying to get from point A to point B.”

City Council Will Be Reconfigured to 11 Districts

In 2016 Fort Worth voters approved a City Charter Amendment to reconfigure City Council districts from nine to eleven. The City Council has appointed an eleven member Redistricting Task Force to advise on redistricting criteria and procedures.

Once the 2020 census figures are available, the task force will start working to divide Fort Worth into 11 smaller districts with roughly equal populations. In December 2018 the Task Force on Race and Culture in recommended the goal of ensuring that the City Council reflects the diverse communities that it represents.

By Dec. 8, 2020, the Task Force will present an interim report on its findings to the City Council. In January 2021 they will hold multiple public hearings, either physically or virtually, at locations throughout the city to solicit community feedback on redistricting criteria and procedures.

The Redistricting Task Force will make present its final recommendations to the City Council on March 2, 2021. All Task force meetings will be open to the public.

Help Keep Summerfields Clean

Become a Code Ranger in Fort Worth and assist in making a positive difference in the appearance of neighborhoods and increased safety. The Code Ranger volunteer program helps Fort Worth code officers identify and respond to code violations throughout the city.

Training sessions are held throughout the year. If you are interested please visit the Code Compliance page on the City of Fort Worth’s web site for more details and contact information.

After attending an initial four-hour training, Code Rangers work in partnership with code officers to improve neighborhoods. Code Rangers are assigned to a neighborhood where they inspect for common violations.

Those violations include overgrown lawns, dilapidated fences, garbage placed out too early, out-of-cycle bulk piles, front yard parking and illegal “bandit” signs, etc.

Code Rangers allow code enforcement officers to devote more time to more dangerous or complicated issues affecting Fort Worth neighborhoods.

Our main code issue in Summerfields is solid waste incorrectly placed curbside. Not following the guidelines usually results in waste not picked up, which detracts from the street's appearance and can lead to fines. No one wants to live in a neighborhood with trash sitting by the street for too long. It detracts from the neighborhood's appearance, makes selling homes more difficult, and eventually lowers property values. Because of this the SNA aggressively monitors waste disposal violations and reports them to Code Compliance. We do not like reporting violations that can result in fines, but there is often no alternatives left to us, We much prefer that residents become educated on the City's waste disposal processes, but will not stand idle while trash accumulates in our neighborhood.

The following are the most common violations we observe:

- Plastic bags containing solid waste (including leaves) placed curbside. *Anything in a plastic bag must be placed in the brown garbage cart to be picked up.* Hardware stores sell acceptable paper yard bags for disposing of yard recyclable waste such as clippings, leaves and small branches
- Bulk waste placed curbside too early, sometimes up to three weeks before the next scheduled pickup. Doing so detracts from the street's appearance and could impact neighbors trying to sell their homes.
- Placing bulk waste too close to objects in the yard. Many of the trucks use hydraulic arms to load waste, and if you place it too close to objects such as mail boxes or light poles it may prevent them from picking it up.
- Different types of bulky waste mixed together. Brush and paper-bagged leaves should be separated from furniture and other bulk items. They are picked up by different trucks and go to different locations. Brush and yard clippings are taken to a City facility where along with the paper bags are converted into mulch. This is the main reason they will not pick up yard waste in non-recyclable plastic bags.
- Mixing waste and recyclable items in the Recycle container. Waste and recyclables are picked up by different trucks. Contaminating the Recycle container with household waste will result in the bin not being emptied.
- Placing household and yard chemicals in the recycle or trash containers. These items should be taken to the Environmental Collection Center (ECC) on Bridge Street. You simply drive though, show your driver's license to show you are a Fort Worth resident, and they empty your vehicle for you. See details on the City's web site.
- Placing any electronic item or major appliance curbside for pick up. All electronics should be taken to Brennen Street for disposal. Electronic items such as TVs have integrated circuitry that contain hazardous chemicals such as arsenic. They are disposed of separately so as not to contaminate the landfills.
- Overflowing Waste and Recycle bins. Called "snow cones" because the lid cannot be closed, they can result in the bin not being emptied. Again, the trucks are automated and if the operator feels they cannot empty the container without spillage they will usually bypass the container, thus leaving the resident with another week before it is again eligible for pick up.
- Trash bins left on the street for days after the scheduled pickup date.

Also remember that small limbs (less than 8 feet in length and four inches in diameter) can be placed curbside for pickup with your scheduled weekly trash. Only larger limbs have to wait for the monthly bulk pick up..

BULK WASTE GUIDELINES

Note: Bulk pickup week for Summerfields begins on the second Monday of each month and runs through the following Saturday. Bulk waste should not be placed curbside until the weekend before your scheduled pickup week. For more information we urge our residents to visit the Solid Waste webpage on the City's website (see the link at the end of this article).

The following information was provided by the City of Fort Worth Solid Waste Department:

Bulk collection is once a month. The New guidelines are in place, so brush up before your next monthly collection

The city's Solid Waste Services has new easy-to-follow steps to make residential bulk collection safer and more effective for pickup. (continued on page 6)

BULK WASTE GUIDELINES—Continued from page 5

The goal is to not only collect the waste, but to dispose of it in a safe manner and, when possible, keep it out of the landfill. For example, tree limbs, branches and yard waste are turned into mulch.

To help curbside pickup go as smoothly as possible, follow the program directions and avoid incurring fines. Here are some best practices and program guidelines:

- Bulk items must be placed on the curb by 7 a.m. Monday of your scheduled collection week. Make sure the pile is not blocked by a vehicle.
- Bulk piles are limited to 10 cubic yards (6 feet by 8 feet by 6 feet), the size of a Volkswagen bug car.
- Plastic bags are not allowed outside the trash cart; residents may incur fines if plastic bags are placed curbside.
- All piles, paper yard waste bags and carts must be separated by at least 2 feet to be collected and to avoid extra fees. No materials can be placed between piles since this creates one large, out-of-compliance pile.
- Any items that fit in the brown garbage cart are not considered bulk and should be put in plastic bags and the placed into the brown garbage cart.
- Large limbs refers to those more than 4 inches in diameter and over eight feet long. Brush smaller than this is considered yard waste and can be collected on your weekly trash pickup day as part of the yard waste collection. It must be separated from carts, large limbs and any bulk pile.

To learn more about the program details, including what materials cannot be set out for bulk collection, check the Solid Waste webpage. <http://fortworthtexas.gov/solid-waste/bulk/>

Solid Waste Services At-A-Glance					
Questions? Download the Fort Worth Garbage & Recycling App					
	WHEN	HOW	AMOUNT/SIZE	DETAILS	NO
YARD	Weekly on pickup day; set out by 7 a.m.	In paper bags, or optional purchase of green yard cart	Unlimited paper yard bags - 30 gallon size	Place 2 ft. from carts or other objects (cars, trees, mailboxes, water and gas meters.)	No plastic bags or trash
Yard Trimmings Leaves, twigs, grass, shrubs					
Brush, Tied Small Branches	Weekly on pickup day; set out by 7 a.m.	Bundled, tied with string or twine	Unlimited bundles, 8 ft. long, 40 lb. max	Place 2 ft. from carts or other objects	No nylon or plastic straps, ties or wire
Brush, Untied Large Branches	Weekly on pickup day; set out by 7 a.m.	Stacked branches only. All branches should be in one pile	Limited to 10 cubic yards (8 ft. long x 6 ft. wide x 6 ft. tall) max, about size of VW Beetle car. Branches no longer than 8 ft. and up to 4 inches in diameter	Place 2 ft. from carts or other objects. More than 10 cubic yds. collected within 72 hours billed to resident	No stumps, plastic bags, trash, fencing, lumber, or household bulk items
RECYCLING	Weekly on pickup day; set out by 7 a.m.	Unbagged items. Close cart lid completely. Clean, dry and empty items.	As much recycling as can fit with the blue cart lid closed. Second blue cart available on request - free.	May take extras to a drop-off station. Only put acceptable items in the cart. Place 2 ft. from carts or other objects	No plastic bags, Styrofoam, paper towels, food, plastic wrap, electronics, clothes, medical waste
Blue Cart Visit website or app for all items that can be recycled.	Can set cart out after 6 p.m. the day before your pickup day				
GARBAGE	Weekly on pickup day; set out by 7 a.m.	In tied plastic bags inside brown cart. Close lid completely. Place 2 ft. from carts or other objects.	Your choice: a -32, 64- or 96-gallon cart (price varies with size). As many bags as can fit in brown cart with lid closed	Options for extra garbage: 1. Take to drop-off station 2. Upgrade cart size 3. Purchase city-authorized Pay Bags	No unbagged items; no bags outside cart or stacked on cart
Brown Cart Household waste only.	Can set cart out after 6 p.m. the day before your pickup day				
BULK ITEMS	Monthly on pickup day; set out by 7 a.m. the Monday of your assigned week; pickup will be any time between that Monday and Saturday	Stacked on curb in one pile. Acceptable items that are too large to fit in the garbage cart. Separate household bulk and large brush piles	Limited to 10 cubic yds. (8 ft long x 6 ft. wide x 6 ft. tall) max; size of a VW Beetle car. More than 10 cubic yds. billed to resident.	Can be set out after 6 p.m. the Friday before your assigned week. Includes fencing, stumps, lumber in bulky pile. Take extra to a drop-off station	No plastic bags, tires, glass, business waste, electronics, sheet-rock, or appliances with coolant or gas
DROP-OFF STATIONS	Open: M-F 8 a.m. - 6 p.m. Sat 8 a.m.- 5 p.m. (Hours subject to change)	Drop-off Station #1: 2400 Brennan Ave. 76106 Drop-off Station #2: 5150 Martin Luther King Jr. Frwy 76119 Drop-off Station #3: 6260 Old Hemphill Rd. 76134 Drop-off Station #4: 301 Hillshire 76052	Bring a recent water bill, drivers license or other official ID to prove Fort Worth residency		No commercial waste, no rock or concrete
Fort Worth Residents Only. Accepting recyclables, brush, electronics, items for Goodwill and more!	Free for Fort Worth Residents				

Summerfields Area Crime Map for October 2020

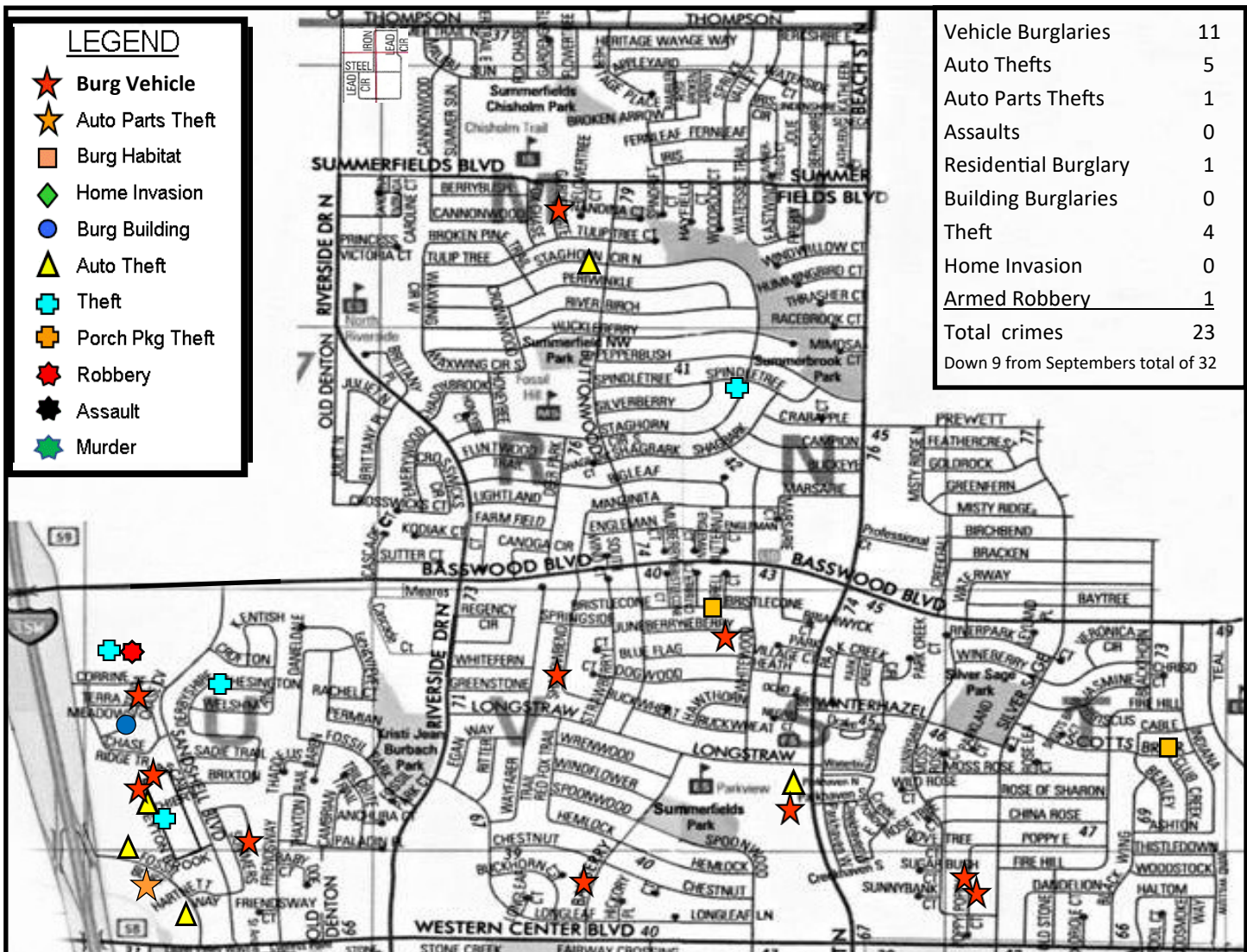

Summerfields Crime Trends for September 2020:

- The majority of car burglaries (BMVs) were of unlocked vehicles, which remains our most common crime.
- Auto thefts remained fairly constant, but still high. Many were unlocked with spare keys/fobs left in the car
- Property crimes were heavily concentrated in restaurants and bars located along Fossil Bluff. If you patronize these establishments it is strongly recommended that you lock your vehicle and leave nothing in view from the outside.
- The one theft of auto parts was a catalytic converter taken from a bar parking lot.
- The auto parts theft was of a license plate.
- The armed robbery was a theft of tools at Home Depot where an actor pulled a gun on store employees when confronted. This turned a misdemeanor theft into a felony armed robbery.

Crime Prevention Recommendations:

- If you park your car in the driveway or on the street, make sure it's locked. Most residential car burglars are local juveniles and now possibly some of the increased homeless people who walk the street at night looking for unlocked vehicles which they enter and rummage through.
- Do not leave anything visible from the outside the vehicle. Doing so could motivate a burglar to forcibly enter.
- Close and lock your garage door. Remember, the door from your garage into your house is usually very flimsy.
- Install motion detector LED lights to illuminate your driveway and property - criminals like the dark.