

THE SUMMERFIELDS

A COMMUNITY WHERE DIVERSITY
IS VALUED, COMMUNICATIONS
ARE ENCOURAGED AND AN
ATTITUDE OF LEARNING FROM
ONE ANOTHER IS RESPECTED



SPOTLIGHT

FOCUS ON THE NEIGHBORHOOD

A Publication of the Summerfields Neighborhood Association

September 2020

AS IF WE DIDN'T HAVE ENOUGH TO WORRY ABOUT....

This has been quite a year for the world. We've had to deal with a pandemic that is threatening our social and economic fabric. We've seen social unrest due to longstanding racial inequality. Like many, I've found it particularly difficult not being able to assemble with my family. I've missed all the grandkids' and great-grandkids' special events - birthdays, soccer games, college graduations and family get-togethers. But with all these distractions, there is still more to worry about, the West Nile Virus.

Several traps in our area continue to capture mosquitos carrying the West Nile Virus. In late August a trap in the Park Glen area was the latest reported event, but Summerfields has had infected mosquitos caught in the trap near the fire station on Longstraw throughout the summer. I just wanted to urge residents to take the proper precautions to lessen the chance of infection. The following was taken from the Tarrant County Public Health notice to the City of Fort Worth:

It is extremely important that our community continue to work together to reduce the mosquito population by removing mosquito habitats from their property and remind their neighbors to do the same.

The most effective means of protection, even more than spraying, is to stay focused on the reduction of the mosquito population:

- Please remove all standing water in empty flower pots, pet bowls, outdoor toys, gutters, etc.
- Maintain your swimming pool. . (continued on page 4)

SNA Presidents Corner



Summerfields, like most of far north Fort Worth, is experiencing a spike in crime. While this is not unusual during the summer months, recent increases have been much higher than previous years. One issue is that the police were stretched thin during the pandemic and covering protests. Beat officers and NPOs were pulled from their normal duties to staff critical areas and cover absences due to officer quarantines exposed to COVID-19. Car and residential burglaries are our biggest issues right now, but we are also seeing a spike in armed robberies in some area businesses and apartments. Domestic disputes climbed dramatically due to the pandemic restrictions.

I want to urge our residents to do their part and secure their property. If you park your car outside overnight, make sure it is locked. Most of our car burglaries are of unlocked vehicles. Make sure to remove anything of value from the car. If thieves see something of value inside the car, it increases the chance they will break a window to get it.

On another note, a resident contacted us about adding trees to the Summerfields Blvd. medians. She has been working with the City's Forestry Department on their free tree program. Due to budget restrictions the SNA cannot financially support this effort, which also requires residents to water the new trees for an extended period. Anyone interested in helping can contact Monica at 682-227-4091

Table of Contents

Pg 2-3	Development
Pg 4	City News
Pg 5-6	Code Issues
Pg 7	Crime Map

MAJOR SINGLE FAMILY DEVELOPMENT SLATED FOR FAR NORTH FORT WORTH

A 3,300 single-family home development has started construction on land west of Texas Motor Speedway on Highway 114. The developer plans to have the first 400 homes available for sale in 2021. This is an example of the continued rapid growth in our area. Alliance Airport has been a fantastic economic engine for Fort Worth, spurring the influx of numerous new major businesses and resulting residential developments. Fort Worth has become one of the fastest growing cities in the country, and Alliance Airport has been a major catalyst for that growth. Tens of thousands of well-paying jobs have been generated and we are seeing an influx of people coming from states with less favorable economies. Nearer to our neighborhood, construction is underway for a multi-purpose development south of the Presidio Shopping Center. Located just west of I35W, this will be a mixed development of businesses, apartments and single family homes. Another major development is in the planning stages for the area west of N. Riverside between Basswood Blvd. and Thompson Road. More information will be provided when available.

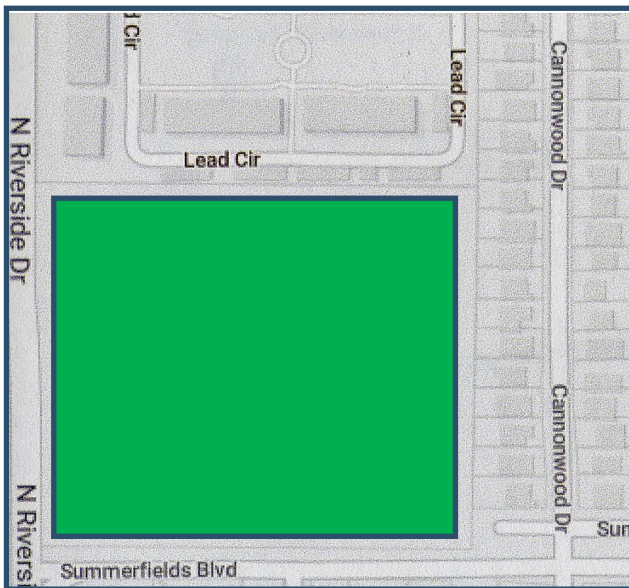

The SNA supported the development of a seniors only (55+) multi-family housing facility on the vacant land located at the northeast intersection of Summerfields Blvd. and N. Riverside Drive. The zoning change request for this facility was approved in August by both the City's Zoning Commission and the City Council.



There is no known date for the start of construction, but we'll pass you updated information when we receive it.

Concept Drawing

Area Road Construction Update

As everyone is probably aware, construction is going full bore on widening N. Riverside Drive to a four lane road from N. Tarrant Parkway south to Basswood Elementary school. This project will also install two traffic circles at the Summerfields Blvd. and Thompson Road intersections with N. Riverside. Currently Thompson Road west of N. Riverside is closed for traffic circle construction, This will make it inconvenient for parents taking to or picking up the children from the Thompson Road Middle School. Please be patient. When completed this will make N. Riverside a four lane road up to North Tarrant. Construction is proceeding well and should be finished, weather permitting, by mid 2021.

A second road improvement project will continue widening N. Riverside Drive from N. Tarrant Parkway north to the existing traffic circle/four lane road at Shiver Road . It is funded and in the design phase . This project will not begin until the current N. Riverside project is complete. This means we have a couple of years before N. Riverside is a four lane road throughout our area.

Other road improvements are planned for the Basswood Blvd. and N. Beach intersection. This project was funded in the City's last Capital Improvement Program and will install two turn lanes in every direction to help alleviate traffic congestion at this busy intersection. No start date is known.



New Eating Establishment Will Open Soon

Lisa's Chicken and Seafood is opening a new location in our area. They are currently renovating the old Wendy's building at the intersection of Sandshell Drive and the I35W north access road, just south of the Braum's. Lisa's has been a fixture in the Stockyards and other areas of Fort Worth for years. The Stockyards location is primarily a takeout facility offering fried chicken and catfish. We do not know as yet if they will have dine-in services at our location. We are pleased to welcome them to the area. It is also good to see a new business open in one of our vacant buildings, especially in these difficult pandemic-induced times.



Standard Multi-Family Apartments Being Considered In Our Area

A developer has been working with Councilman Cary Moon and area neighborhood organizations, including the SNA, to construct a 200 unit apartment complex on the land bordered by Fossil Bluff, Hartnett, and Sandshell Blvd. This is the land just to the south of the Carriage Place townhomes who's Association we are supporting.

While the SNA has traditionally opposed new standard multi-family zoning changes, this is not a normal situation. This site is currently zoned G, high intensity commercial. This type of zoning allows several large non-residential facilities such as the Main Event bowling and gaming center in the Presidio Shopping area. Because of the risk of such

G-zoned facilities building on this land, we are leaning toward supporting this multi-family development.



Concept Drawings from the Developer. Final design is yet to be finalized.

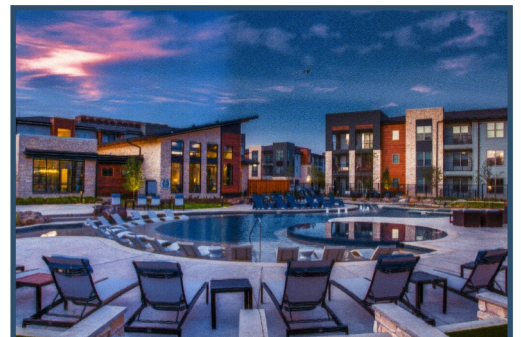

West Nile Virus (continued from page 1)

- When you're outdoors, remember to wear repellent that contains DEET.
- Wear clothing with long sleeves and pants when applicable.

IMPORTANT UPDATES

Continued vigilance when it comes to preventing the spread of mosquito viruses in our community is essential. (continued on page 4)

Since there have been West Nile Virus positive mosquitoes in your neighborhood, the city's Code Compliance officers will be monitoring the area looking for litter and debris that could invite mosquitoes to breed and nest.

You can help by keeping your grass mowed and trees trimmed.

If there's an issue with standing water at a location that is not city property, report it to the City's Customer Care Center at 817-392-1234.

U.S. Census Update

If you have not yet completed the census for your household, we urge you to do so. Fort Worth is growing rapidly, and we need to assure everyone is counted. An accurate count is very important and determines many important decisions. With Texas growth, the higher population could give us extra seats in the U.S. House of Representatives. Also, many Federally funded programs are distributed to the states on the basis of population. Please assure you are counted.

The following was taken from the City of Fort Worth's Daily News Update and gives you options for being counted:

More than 73% of housing units have been accounted for in the 2020 Census, with 9.7% counted by census takers and other field data collection operations, and 64.2% of housing units responding online, by phone or by mail.

The nonresponse follow-up completion rate, released for the first time during a decennial census, details the percentage of households that have been visited by a census taker and marked as complete. A household can be marked as complete with a household completing the interview or a housing unit address being marked as vacant or nonexistent.

The nonresponse follow-up operation involves census takers visiting households that have not yet responded. This is the final stage of data collection for the once-a-decade population count of everyone living in the United States.

Households can still [respond now by responding online](#), by phone at 844-330-2020 or by completing and mailing back their paper questionnaire. Households can respond online or by phone in one of 13 languages. Responding now may minimize the need for a census taker to visit. Some households that have already responded to the census may still be visited by a census taker conducting quality checks.



Our main issue in Summerfields is solid waste incorrectly placed curbside. Not following the guidelines usually results in waste not picked up, which detracts from the street's appearance and can lead to fines. No one wants to live in a neighborhood with trash sitting by the street for too long. It detracts from the neighborhood's appearance, makes selling homes more difficult, and eventually lowers property values. Because of this the SNA aggressively monitors waste disposal violations and reports them to Code Compliance. We do not like reporting violations that can result in fines, but there is often no alternatives left to us, We much prefer that residents become educated on the City's waste disposal processes, but will not stand idle while trash accumulates in our neighborhood.

The following are the most common violations we observe:

- Plastic bags containing solid waste (including leaves) placed curbside. *Anything in a plastic bag must be placed in the brown garbage cart to be picked up.* Hardware stores sell acceptable paper yard bags for disposing of yard recyclable waste such as clippings, leaves and small branches
- Bulk waste placed curbside too early, sometimes up to three weeks before the next scheduled pickup. Doing so detracts from the street's appearance and could impact neighbors trying to sell their homes.
- Placing bulk waste too close to objects in the yard. Many of the trucks use hydraulic arms to load waste, and if you place it too close to objects such as mail boxes or light poles it may prevent them from picking it up.
- Different types of bulky waste mixed together. Brush and paper-bagged leaves should be separated from furniture and other bulk items. They are picked up by different trucks and go to different locations. Brush and yard clippings are taken to a City facility where along with the paper bags are converted into mulch. This is the main reason they will not pick up yard waste in non-recyclable plastic bags.
- Mixing waste and recyclable items in the Recycle container. Waste and recyclables are picked up by different trucks. Contaminating the Recycle container with household waste will result in the bin not being emptied.
- Placing household and yard chemicals in the recycle or trash containers. These items should be taken to the Environmental Collection Center (ECC) on Bridge Street. You simply drive though, show your driver's license to show you are a Fort Worth resident, and they empty your vehicle for you. See details on the City's web site.
- Placing any electronic item or major appliance curbside for pick up. All electronics should be taken to Brennen Street for disposal. Electronic items such as TVs have integrated circuitry that contain hazardous chemicals such as arsenic. They are disposed of separately so as not to contaminate the landfills.
- Overflowing Waste and Recycle bins. Called "snow cones" because the lid cannot be closed, they can result in the bin not being emptied. Again, the trucks are automated and if the operator feels they cannot empty the container without spillage they will usually bypass the container, thus leaving the resident with another week before it is again eligible for pick up.
- Trash bins left on the street for days after the scheduled pickup date.

Also remember that small limbs (less than 8 feet in length and four inches in diameter) can be placed curbside for pickup with your scheduled weekly trash. Only larger limbs have to wait for the monthly bulk pick up..

BULK WASTE GUIDELINES

Note: Bulk pickup week for Summerfields begins on the second Monday of each month and runs through the following Saturday. Bulk waste should not be placed curbside until the weekend before your scheduled week. For more information we urge our residents to visit the Solid Waste webpage on the City's website (see the link at the end of this article).

The following information was provided by the City of Fort Worth Solid Waste Department:

Bulk collection is once a month. The New guidelines are in place, so brush up before your next monthly collection

The city's Solid Waste Services has new easy-to-follow steps to make residential bulk collection safer and more effective for pickup. (continued on page 6)

BULK WASTE GUIDELINES—Continued from page 5

The goal is to not only collect the waste, but to dispose of it in a safe manner and, when possible, keep it out of the landfill. For example, tree limbs, branches and yard waste are turned into mulch.

To help curbside pickup go as smoothly as possible, follow the program directions and avoid incurring fines. Here are some best practices and program guidelines:

- Bulk items must be placed on the curb by 7 a.m. Monday of your scheduled collection week. Make sure the pile is not blocked by a vehicle.
- Bulk piles are limited to 10 cubic yards (6 feet by 8 feet by 6 feet), the size of a Volkswagen bug car.
- Plastic bags are not allowed; residents may incur fines if plastic bags are placed curbside.
- All piles, paper yard waste bags and carts must be separated by at least 2 feet to be collected and to avoid extra fees. No materials can be placed between piles since this creates one large, out-of-compliance pile.
- Any items that fit in the brown garbage cart are not considered bulk and should be put in plastic bags and the placed into the brown garbage cart.
- Large limbs refers to those more than 4 inches in diameter and over eight feet long. Brush smaller than this is considered yard waste and can be collected on your weekly trash pickup day as part of the yard waste collection. It must be separated from carts, large limbs and any bulk pile.

To learn more about the program details, including what materials cannot be set out for bulk collection, check the Solid Waste webpage. <http://fortworthtexas.gov/solidwaste/bulk/>

Solid Waste Services At-A-Glance					
Questions? Download the Fort Worth Garbage & Recycling App					
	WHEN	HOW	AMOUNT/SIZE	DETAILS	NO
YARD	Weekly on pickup day; set out by 7 a.m.	In paper bags, or optional purchase of green yard cart	Unlimited paper yard bags - 30 gallon size	Place 2 ft. from carts or other objects (cars, trees, mailboxes, water and gas meters.)	No plastic bags or trash
Yard Trimmings Leaves, twigs, grass, shrubs					
Brush, Tied Small Branches	Weekly on pickup day; set out by 7 a.m.	Bundled, tied with string or twine	Unlimited bundles, 8 ft. long, 40 lb. max	Place 2 ft. from carts or other objects	No nylon or plastic straps, ties or wire
Brush, Untied Large Branches	Weekly on pickup day; set out by 7 a.m.	Stacked branches only. All branches should be in one pile	Limited to 10 cubic yards (8 ft. long x 6 ft. wide x 6 ft. tall) max, about size of VW Beetle car. Branches no longer than 8 ft. and up to 4 inches in diameter	Place 2 ft. from carts or other objects. More than 10 cubic yds. collected within 72 hours billed to resident	No stumps, plastic bags, trash, fencing, lumber, or household bulk items
RECYCLING	Weekly on pickup day; set out by 7 a.m.	Unbagged items. Close cart lid completely. Clean, dry and empty items.	As much recycling as can fit with the blue cart lid closed. Second blue cart available on request - free.	May take extras to a drop-off station. Only put acceptable items in the cart. Place 2 ft. from carts or other objects	No plastic bags, Styrofoam, paper towels, food, plastic wrap, electronics, clothes, medical waste
Blue Cart Visit website or app for all items that can be recycled.	Can set cart out after 6 p.m. the day before your pickup day				
GARBAGE	Weekly on pickup day; set out by 7 a.m.	In tied plastic bags inside brown cart. Close lid completely. Place 2 ft. from carts or other objects.	Your choice: a -32, 64- or 96-gallon cart (price varies with size). As many bags as can fit in brown cart with lid closed	Options for extra garbage: 1. Take to drop-off station 2. Upgrade cart size 3. Purchase city-authorized Pay Bags	No unbagged items; no bags outside cart or stacked on cart
Brown Cart Household waste only.	Can set cart out after 6 p.m. the day before your pickup day				
BULK ITEMS	Monthly on pickup day; set out by 7 a.m. the Monday of your assigned week; pickup will be any time between that Monday and Saturday	Stacked on curb in one pile. Acceptable items that are too large to fit in the garbage cart. Separate household bulk and large brush piles	Limited to 10 cubic yds. (8 ft long x 6 ft. wide x 6 ft. tall) max; size of a VW Beetle car. More than 10 cubic yds. billed to resident.	Can be set out after 6 p.m. the Friday before your assigned week. Includes fencing, stumps, lumber in bulky pile. Take extra to a drop-off station	No plastic bags, tires, glass, business waste, electronics, sheet-rock, or appliances with coolant or gas
DROP-OFF STATIONS	Open: M-F 8 a.m. - 6 p.m. Sat 8 a.m.- 5 p.m. (Hours subject to change)	Drop-off Station #1: 2400 Brennan Ave. 76106 Drop-off Station #2: 5150 Martin Luther King Jr. Frwy 76119 Drop-off Station #3: 6260 Old Hemphill Rd. 76134 Drop-off Station #4: 301 Hillshire 76052	Bring a recent water bill, drivers license or other official ID to prove Fort Worth residency		No commercial waste, no rock or concrete
Fort Worth Residents Only. Accepting recyclables, brush, electronics, items for Goodwill and more!	Free for Fort Worth Residents				

Summerfields Area Crime Map for August 2020

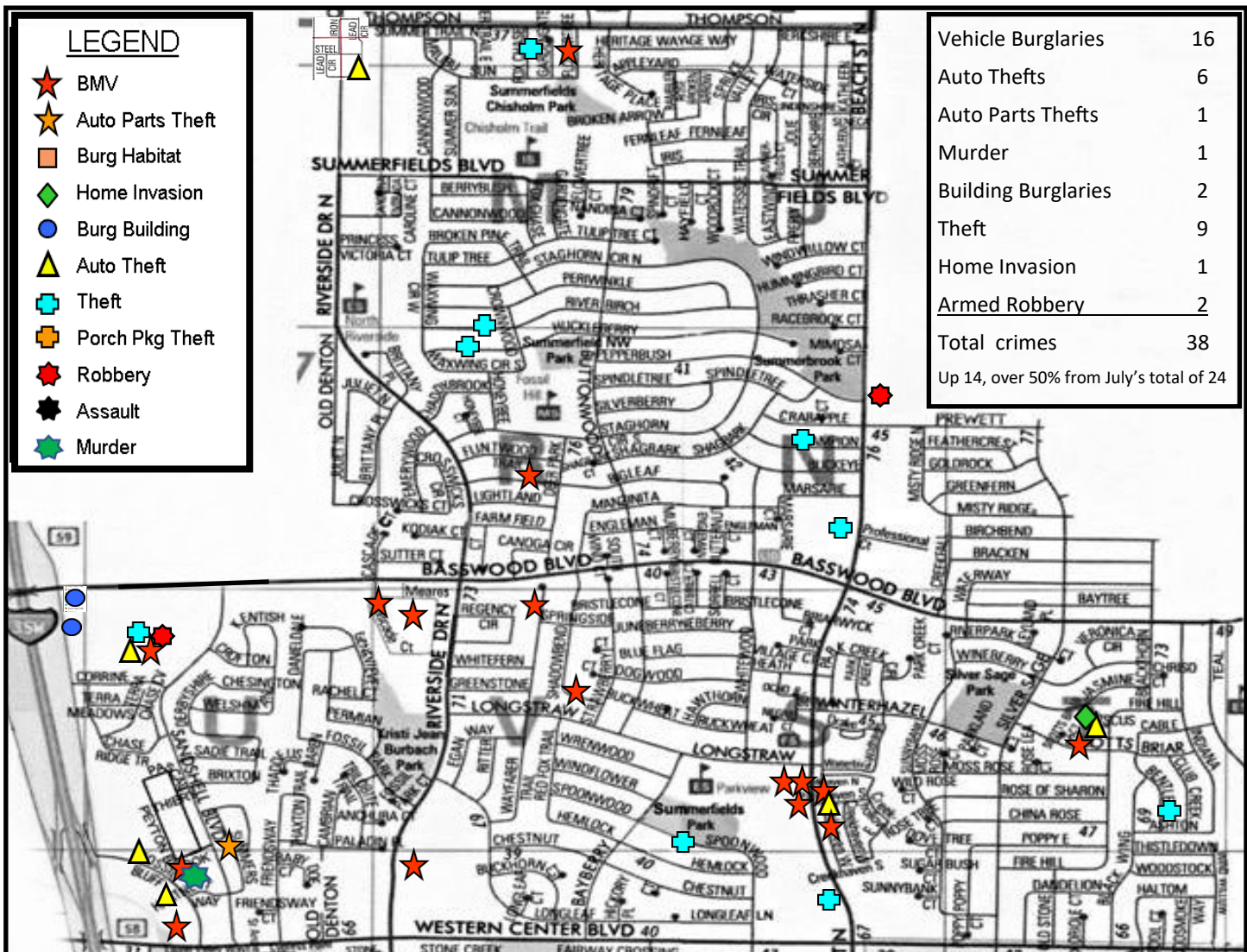

Summerfields Crime Trends for August 2020:

- The majority of car burglaries were of unlocked vehicles. Unlocked car burglaries remain our most common crime.
- Auto thefts remained constant, but still high.
- No pattern to BMVs, they were spread across single family and apartment residence, businesses and hotels. The only concentration was in two apartment complexes.
- The auto parts theft was of a license plate.
- The two armed robberies are concerning. We are seeing a rise in this violent crime in the area.

Crime Prevention Recommendations:

- If you park your car in the driveway or on the street, make sure it's locked. Most residential car burglars are juvenile "door pullers" who walk the street at night looking for unlocked vehicles which they enter and rummage through.
- Do not leave anything visible from the outside the vehicle. Doing so could motivate a burglar to forcibly enter.
- Close and lock your garage door. Remember, the door from your garage into your house is usually very flimsy.
- Install motion detector LED lights to illuminate your property - criminals like the dark.
- Report juveniles walking the residential streets after midnight., especially if they wear hoodies and have backpacks.